

Screw shaft diameter $\phi 10\text{-}\phi 12$

C-8

Custom Ball Screw: TUBE METHOD SINGLE NUT (Accuracy grade C0-C10)

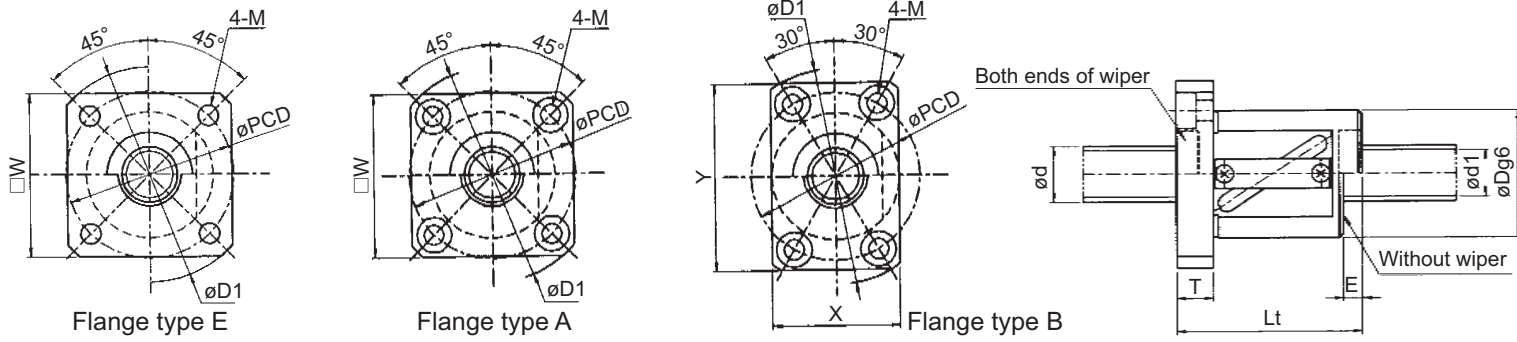

(Unit: mm)

Model No.	Screw shaft diameter d	Lead L	Ball diameter D_b	Root diameter d_r	Number of circuits Turn x Circuit	Basic dynamic load rating C (N)	Basic static load rating C_0 (N)	*Rigidity K_{NS} (N/ μ m)	Nut dimensions															Mass				
									Outer diameter D	Overall length L_t	Wiper material	Without wiper E	Flange thickness T	Flange outer diameter D_f	Flange type	Flange dimensions						PCD	Mounting hole			Nut (kg)	Screw shaft (kg/100mm)	
																W	X	Y	A	B	G		Q	Drill	Spot facing			Depth
GR1001JS-EDNR	10	1	0.8000	9.3	1x3	750	1750	70	19	22	N	—	5	36	E	29	—	—	—	—	—	—	27	4.5	—	—	0.05	0.06
GR101FDS-EAFR	10	1.5	1.0000	9.1	2.5x1	850	2300	60	19	24	F	5	5	36	E	29	—	—	—	—	—	—	27	4.5	—	—	0.06	0.06
GR1002DS-EAFR	10	2	1.5875	8.6	2.5x1	2250	3300	70	23	30	F	3	5	40	E	31	—	—	—	—	—	—	31	4.5	—	—	0.09	0.06
GR102FDS-AAFR	10	2.5	2.0000	8.3	2.5x1	2700	4200	70	24	35	F	5	8	43	A	33	—	—	—	—	—	—	32	4.5	8	4.4	0.13	0.06
GR1003DS-AAPR	10	3	2.0000	8.3	2.5x1	2700	4200	70	24	36	P	6	8	43	A	33	—	—	—	—	—	—	32	4.5	8	4.4	0.13	0.06
GR1004DS-AAPR	10	4	2.3812	8.1	2.5x1	3350	5900	75	26	37	P	3	8	45	A	35	—	—	—	—	—	—	34	4.5	8	4.4	0.16	0.06
GR1004DS-BAPR	10	4	2.3812	8.1	2.5x1	3350	5900	75	26	37	P	3	8	46	B	—	28	42	—	—	—	—	36	4.5	8	4.4	0.15	0.06
GR1005DS-AAPR	10	5	2.3812	8.1	2.5x1	3350	5900	75	26	40	P	5	8	45	A	35	—	—	—	—	—	—	34	4.5	8	4.4	0.17	0.06
GR1005DS-BAPR	10	5	2.3812	8.1	2.5x1	3350	5900	75	26	40	P	5	8	46	B	—	28	42	—	—	—	—	36	4.5	8	4.4	0.16	0.06
GR1010AS-AAPR	10	10	2.3812	8.1	1.5x1	2200	3500	50	28	40	P	6	8	47	A	36	—	—	—	—	—	—	36	4.5	8	4.4	0.19	0.06
GR1010AS-BAPR	10	10	2.3812	8.1	1.5x1	2200	3500	50	28	40	P	6	8	47	B	—	30	45	—	—	—	—	36	4.5	8	4.4	0.20	0.06
GR1202DS-AAPR	12	2	1.5875	10.6	2.5x1	2450	4100	85	25	35	P	5	8	44	A	34	—	—	—	—	—	—	33	4.5	8	4.4	0.13	0.09
GR122FDS-AAPR	12	2.5	2.0000	10.3	2.5x1	2950	5100	85	26	34	P	4	8	45	A	35	—	—	—	—	—	—	34	4.5	8	4.4	0.14	0.09
GR1203DS-AAPR	12	3	2.0000	10.3	2.5x1	2950	5100	85	26	35	P	5	8	45	A	35	—	—	—	—	—	—	34	4.5	8	4.4	0.14	0.09
GR1204DS-AALR	12	4	2.3812	10.1	2.5x1	3600	6750	85	30	41	L	5	10	54	A	41	—	—	—	—	—	—	41	5.5	9.5	5.4	0.25	0.09
GR1205DS-AALR	12	5	3.1750	9.5	2.5x1	5950	9800	90	30	44	L	3	10	54	A	41	—	—	—	—	—	—	41	5.5	9.5	5.4	0.25	0.09
GR1205DS-BALR	12	5	3.1750	9.5	2.5x1	5950	9800	90	30	44	L	3	10	50	B	—	32	45	—	—	—	—	40	4.5	8	4.4	0.23	0.09
GR1206DS-AAPR	12	6	3.1750	9.5	2.5x1	5950	9800	90	30	45	P	3	10	54	A	41	—	—	—	—	—	—	41	5.5	9.5	5.4	0.25	0.09
GR1206DS-BAPR	12	6	3.1750	9.5	2.5x1	5950	9800	90	30	45	P	3	10	54	B	—	32	48	—	—	—	—	41	5.5	9.5	5.4	0.24	0.09
GR1210AS-AALR	12	10	3.1750	9.5	1.5x1	3850	5900	60	30	49	L	7	12	54	A	41	—	—	—	—	—	—	41	5.5	9.5	5.4	0.28	0.09
GR1210AS-BALR	12	10	3.1750	9.5	1.5x1	3850	5900	60	30	49	L	7	12	54	B	—	32	48	—	—	—	—	41	5.5	9.5	5.4	0.27	0.09
GR1220AS-AALR	12	20	3.1750	9.5	1.5x1	3850	5900	60	32	68	L	7	12	56	A	43	—	—	—	—	—	—	43	5.5	9.5	5.4	0.42	0.09
GR1220AS-BALR	12	20	3.1750	9.5	1.5x1	3850	5900	60	32	68	L	7	12	56	B	—	32	48	—	—	—	—	43	5.5	9.5	5.4	0.39	0.09

Note: • The rigidity indicated with the *mark in the above list represents the operational value based on the result of rigidity testing. This value is calculated from the elastic displacement measured when the axial load equivalent to 30% of basic dynamic load rating (C) is applied between the screw thread and the balls.

• Wiper material F: Felt wiper, P: Plastic wiper, L: Lip seal, N: Without wiper

KURODA
VIA JENATEC

GR series

Screw shaft diameter $\phi 10\text{-}\phi 12$