

## FG series (Accuracy grade C5) / FE series (Accuracy grade C7)

### Ball screw specifications

|   |                                  |               |               |
|---|----------------------------------|---------------|---------------|
| Shaft diameter (mm) - Lead (mm)         | 25 - 25                          |               |               |
| Number of circuits / Thread direction   | 1.7 turns 1 circuit / Right-hand |               |               |
| Ball diameter (mm)                      | 4.7625                           |               |               |
| Root diameter (mm)                      | 21.0                             |               |               |
| Series                                  | FG                               | FE            |               |
| Basic dynamic load rating C (N)         | 13100                            |               |               |
| Basic static load rating C0 (N)         | 25900                            |               |               |
| Accuracy grade / Axial clearance symbol | C5 / S                           | C5 / F        | C7 / M        |
| Axial clearance (mm)                    | 0                                | 0.005 or less | 0.030 or less |
| Preload torque (N·cm)                   | 6.0 to 32.0                      | Up to 6.0     | ----          |
| Spacer ball                             | None                             |               |               |
| Recirculation system                    | End deflector method             |               |               |
| Wiper                                   | None                             |               |               |
| Lubricant                               | Alvania Grease S2                |               |               |

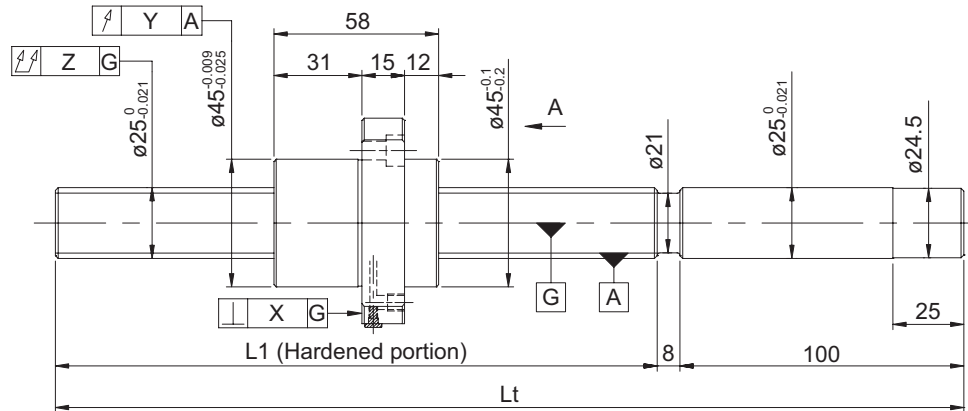
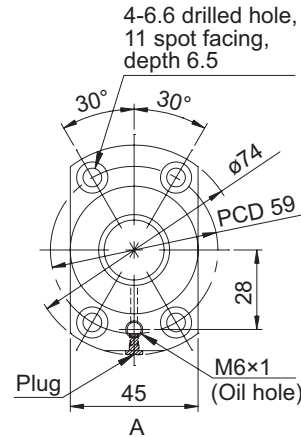

| Model No.<br>(Unfinished shaft ends) | Screw shaft length |      | Maximum stroke<br>(L1 - nut length) | Lead accuracy |       |           |
|--------------------------------------|--------------------|------|-------------------------------------|---------------|-------|-----------|
|                                      | L1                 | Lt   |                                     | $\pm E_c$     | $e_c$ | $e_{300}$ |
| FG2525PS-HPNR-1020A                  | 912                | 1020 | 854                                 | 0.040         | 0.027 | 0.018     |
| FG2525PS-HPNR-1520A                  | 1412               | 1520 | 1354                                | 0.054         | 0.035 |           |
| FE2525PS-HPNR-1020A                  | 912                | 1020 | 854                                 | 0.05/300      | ----  | ----      |
| FE2525PS-HPNR-1520A                  | 1412               | 1520 | 1354                                |               |       |           |

- Product with axial clearance of 0.005 or less (F) shown may be partially preloaded.
- Preload torque is a value before applying grease.

## Screw shaft diameter $\phi 25$ , Lead 25

### Shaft end finish type

Standard precision ball screws are available with KURODA's recommended shaft end finish types for each size.

Other than KURODA's recommended shaft end finish types described below, additional machining including keyways, tapped holes, and D-cut processing are also available if requested. Please contact KURODA with your orders. Model examples for finished shaft ends are described below.

**Model example:** Unfinished shaft ends (See left figure) → Finished shaft ends

FG2525PS-HPNR-1520A → FG2525PS-HPNR-1520X1394-C5F  
 ↳ Thread length  
 ↳ Overall screw shaft length

| Supported end                         | Fixed end                         |
|---------------------------------------|-----------------------------------|
|                                       |                                   |
| Applicable supported end support unit | Applicable fixed end support unit |
| BUK-20S (Square type)                 | BUK-20, BUK-20F (Square type)     |
| BUM-20S (Round type)                  | BUM-20, BUM-20F (Round type)      |

### Optional specifications

- Ball screw lubricating unit LUBSEAL can be equipped. The overall nut length will be 11 mm longer.

**Model example:** FG2525PS-HPSR-1520X1394-C5F

↳ Wiper material S: LUBSEAL

- Anticorrosive black coating (coating thickness: 1 to 2  $\mu\text{m}$ ) is available.

| Accuracy of each part |       |       |       |       | Preload torque (N·cm) |                | Mass (kg) |
|-----------------------|-------|-------|-------|-------|-----------------------|----------------|-----------|
| X                     | Y     | Z     | U     | V     | Without clearance     | With clearance |           |
| 0.011                 | 0.015 | 0.100 | 0.013 | 0.005 | 6.0 to 32.0           | Up to 6.0      | 4.39      |
|                       |       | 0.130 |       |       | 6.0 to 32.0           |                |           |
| 0.018                 | 0.030 | 0.150 | ----  | ----  | ----                  | ----           | 4.39      |
|                       |       | 0.190 |       |       |                       |                |           |

- At the time of delivery, grease is inserted inside of the nut, with rust-preventive oil also applied. Before and during use, apply lubricant where appropriate.
- For models with lead accuracy grade of C3 or higher and unfinished shaft ends, consult KURODA.